

Inference for SPDEs and related topics  
Prague-Berlin workshop

INFORMATION AND SCHEDULE

September 26-27, 2024  
Prague

## SCHEDULE - THURSDAY SEPTEMBER 26

8:30 – 9:00	Registration and Opening
9:00 – 9:45	Wilhelm Stannat and Jan Szalankiewicz <i>Filtering SPDEs with spatio-temporal point process observations</i>
9:45 – 10:30	Mathias Trabs <i>Non-parametric estimation for linear SPDEs on arbitrary domains based on discrete observations</i>
10:30 – 11:00	Coffee
11:00 – 11:30	Randolf Altmeyer <i>The LAN property for local measurements</i>
11:30 – 12:00	Oana Lang <i>Generative modelling and stochastic parameterisations for a rotation shallow water system</i>
12:00 – 12:30	Martin Ondreját <i>Numerical approximation of the stochastic total variation flow</i>
12:30 – 14:00	Lunch
14:00 – 14:30	Pavel Kříž <i>Estimating Hurst parameter for stochastic heat equation - spectral approach</i>
14:30 – 15:00	Gregor Pasemann <i>Nonparametric diffusivity estimation for the stochastic heat equation from noisy observations</i>
15:00 – 15:30	Josef Janák <i>Parameter estimation for the stochastic heat equation with multiplicative noise from local measurements</i>
15:30 – 15:45	Coffee
15:45 – 16:15	Sascha Gaudlitz <i>Bayesian inference in semi-linear SPDEs using spatial information</i>
16:15 – 16:45	Eric Ziebell <i>Parameter estimation in hyperbolic linear SPDEs from multiple measurements</i>

## SCHEDULE - FRIDAY SEPTEMBER 27

9:00 – 9:45	Ciprian A. Tudor <i>Multidimensional Stein-Malliavin calculus and asymptotic independence</i>
9:45 – 10:30	Igor Cialenko <i>Viscosities estimation for Stochastic Primitive Equations</i>
10:30 – 11:00	Coffee
11:00 – 11:30	Petr Čoupek <i>Besov-Orlicz regularity of stochastic processes</i>
11:30 – 12:00	Jakub Slavík <i>Abstract sewing lemma</i>
12:00 – 12:30	František Hendrych <i>Differential equations driven by exponential Besov-Orlicz paths</i>
12:30	Closing and lunch

## PRAGUE PUBLIC TRANSPORT

In Prague, the public transportation system is very good and you can get around quite easily - either by a bus, tram, or by the underground (called “metro” by the locals).

You can buy the tickets from the yellow machines that are at the bus stop at the airport or at the entrance to every metro station. The tickets have to be stamped at the small yellow boxes near every door of the tram/bus when you first board a vehicle or enter a metro station. For hassle-free travel we recommend that you get either a 24-hour<sup>1</sup> (120 CZK  $\sim$  5 EUR) or a 72-hour ticket (330 CZK  $\sim$  13 EUR).

### GETTING TO THE CITY CENTER

The city center is anything between the metro stations Staroměstská, Florenc, Náměstí míru, I.P. Pavlova, and Národní třída. The main historical sights are best accessible either from Malostranská if you want to see the Prague Castle or Staroměstská, Můstek, or Náměstí republiky if you want to see the Old Town or the old Jewish quarter.

- **From the airport**

At the airport, the bus stops are located directly in front of the terminals. You can buy the tickets from the yellow machines directly at the bus stop. The easiest way to get to the city center is to take (trolley-)bus no. 59. The bus runs only between the airport and Nádraží Veveř metro station. From there, you can change to the metro **line A** and go in the direction Depo Hostivař.

- **From the main train station**

If you arrive at the main train station (Hlavní nádraží), you are pretty much in the city center. There is a metro **line C** station Hlavní nádraží.

- **From the main coach station**

If you arrive at the main coach station (ÚAN Florenc), you are pretty much in the city center. There are both metro **line B** and **line C**, station Florenc, nearby.

### GETTING TO THE WORKSHOP

The workshop will take place in the building of the School of Mathematics, Faculty of Mathematics and Physics, Charles University. The address is Sokolovská (street) 83 and you can get there by the metro (**line B**, station Křižíkova) or by a tram (lines 6, 8, 12, and 29, stop Křižíkova). The workshop will then take place in room K1 on the 2<sup>nd</sup> floor.

---

<sup>1</sup>A ticket is valid from the moment you stamp it. For example, if you stamp a 24-hour ticket at 19:34, you can use it until 19:34 the next day.



# PRAHA

# PRAGUE

## Orientační plán metra

## Metro map

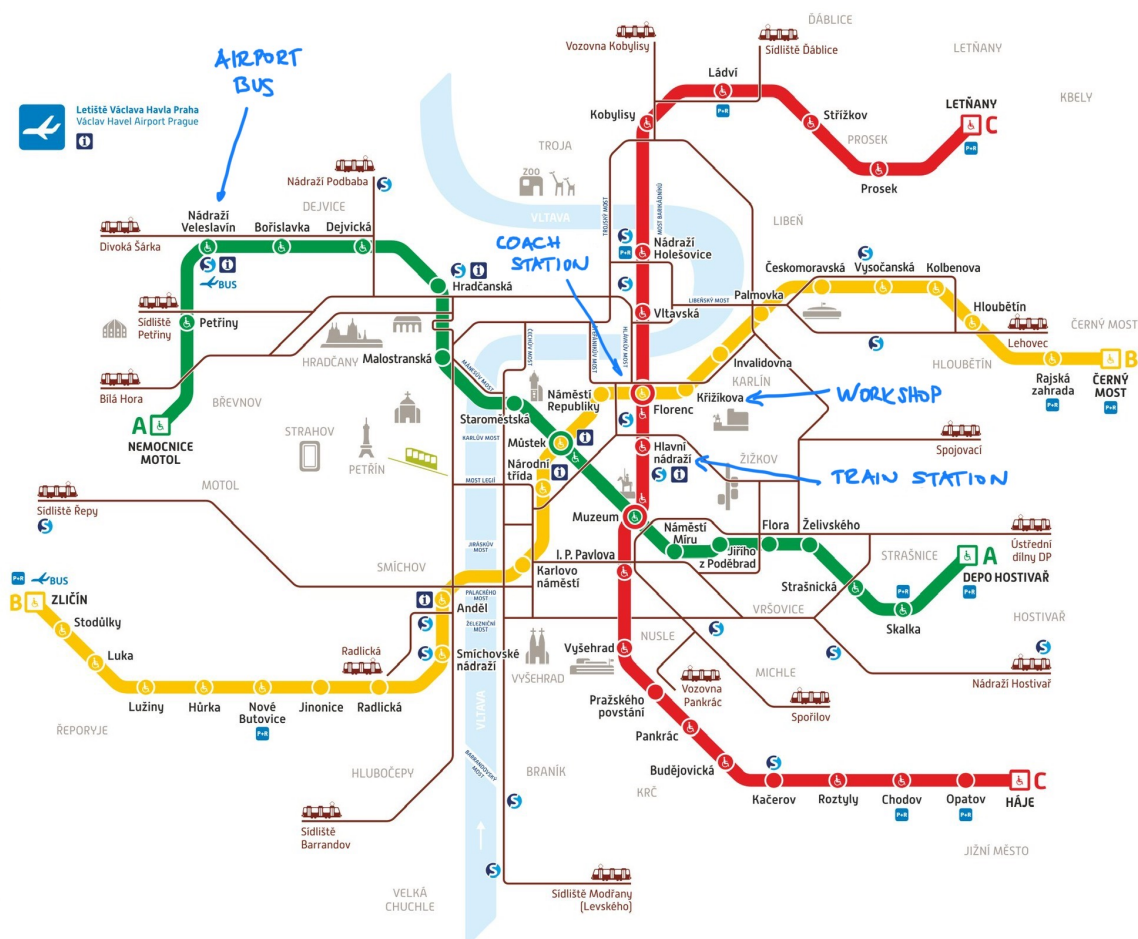

**A B C** Linky a stanice metra  
Metro lines and stations

**Bezbariérový přístup**  
Barrier-free access

**Bus MHD na Letišti Václava Havla Praha**  
Public transport buses to Václav  
Havel Airport Prague

**Parkoviště P+R**  
Park and ride

**Konečná stanice metra**  
Metro terminus station

**Tramvajová trať**  
Tram line

**Přestup na linky S a další vlakové spoje**  
Transfer to lines S and other railway lines

**Infocentrum DP**  
Public transport information

**Stanice přestupní**  
Transfer station

**Lanová dráha**  
Funicular

© Dopravní podnik hl. m. Prahy, akciová společnost  
březen 2016



**296 19 18 17**  
www.dpp.cz

Dopravní podnik  
hlavního města Prahy

**PID** PRAŽSKÁ  
INTEGROVANÁ  
DOPRAVA

# SCHEMATICS OF THE SCHOOL OF MATHEMATICS

## GROUND FLOOR

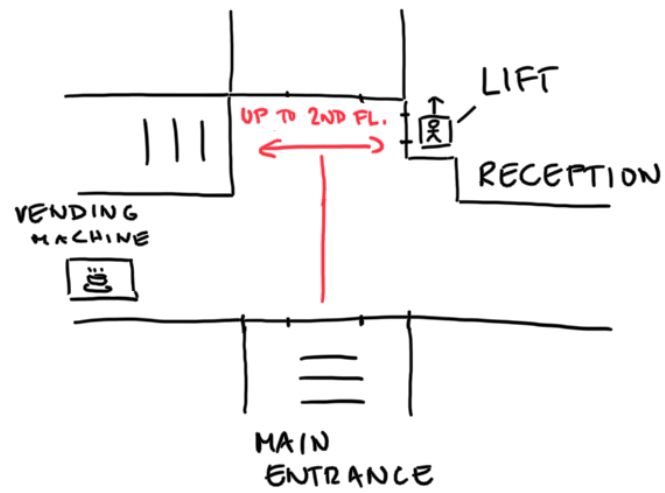

## 2<sup>ND</sup> FLOOR

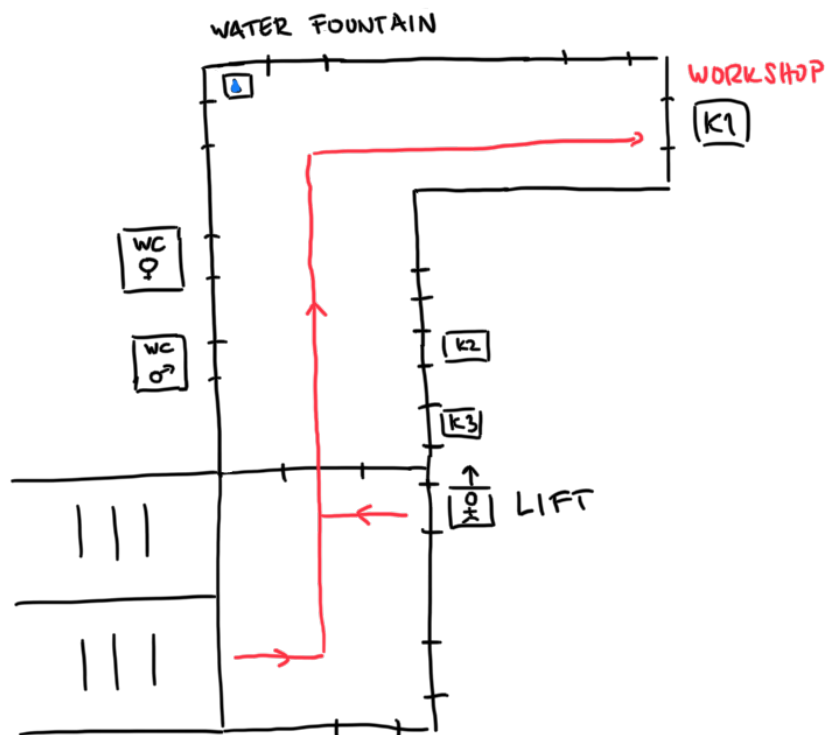

## RESTAURANTS, CAFÉS, AND BARS IN KARLÍN

There are many really good restaurants with reasonable prices within a couple of minutes on foot from the faculty. In most places, you can pay by standard credit/debit cards (Apple/Google Pay and similar work of course as well) but there are some (very rare) exceptions. In most places, especially during lunch time, it is common that the bill is split (the waiting staff will usually ask you to come to the cash box where you tell them what you would like to pay). As far as tipping is concerned, it is customary to give approx. 10% tip by saying the total amount that you wish to pay (e.g. they tell you “It’ll be 319 CZK.” and you will say something like “Make it 350 CZK.”)

### Restaurants

If you are in mood for some typical Czech dishes, try [Lokál Hamburk](#) or [U Tunelu](#). If you like Mexican, you might like [La Patrona](#). For Asian cuisine, we recommend [Khomfi](#) or [Deli Bowl](#). For more traditional but amazing dishes, try [Krystal Bistro](#). If someone prefers burgers, [Peter’s Pub](#) is the right choice.

### Cafés

As you will surely notice, Karlín is somewhat the hip quarter so if you are a coffee lover, you will have plenty of choices - we would recommend [Pekárna Praktika](#) that is right next door to the faculty and where they make their own amazing pastry, [EMA espresso bar](#), or [Grounds S16](#) where they roast their own coffee. If you do not mind standing, try the supercozy [Kafé Garáž](#).

### Pubs and bars

There are quite a few places in Karlín to get a few beers - [Lokál Hamburk](#) or [Dva Kohouti](#) for the classical pilsner, [U Tunelu](#) for a very Czech experience, or [Diego Pivní Bar](#) for a wide selection of local beers (in Diego, they only take cash though) to name but a few. If you like margaritas, try [La Patrona](#). If you like other mixed drinks, [Revír Karlín](#) would be a good choice. For decent wine selection, try [Veltlín](#).